

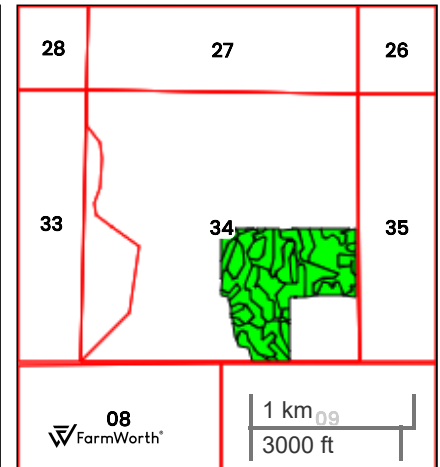

109.6 AC - FREEBORN COUNTY (109.60 AC TOTAL, 107.88 AC TILLABLE)

## TOTAL SOILS

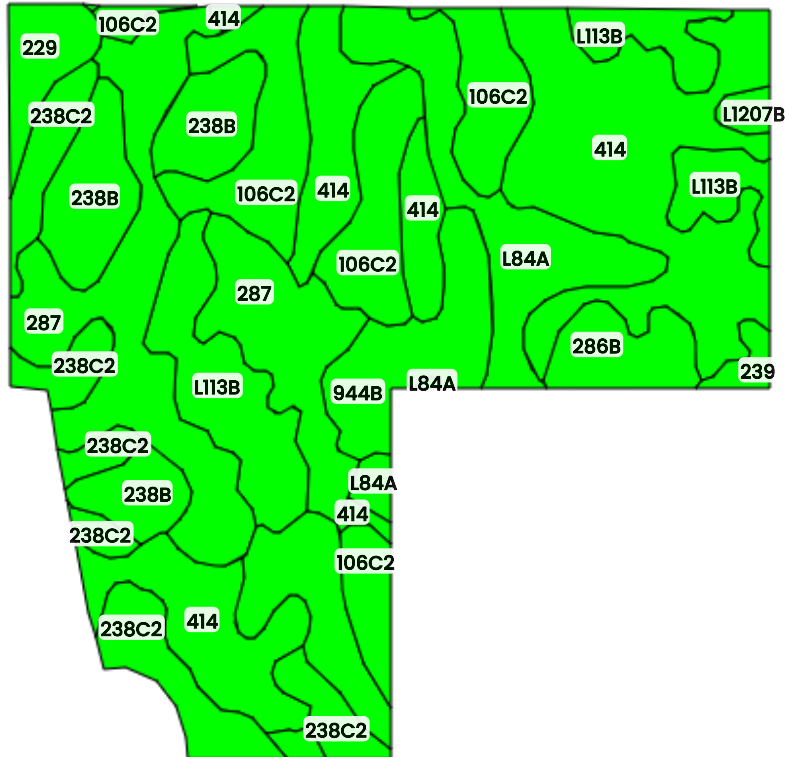

County: Freeborn County, MN

Location: 34-101N-22W

Township: Nunda

Acres: 109.60

Date: 10/22/2025



Field borders obtained from Farm Service Agency  
as of 2008

FarmWorth, LLC makes no representations or warranties, express or implied, as to the accuracy of any information, data, numerical values, boundaries, or any other information generated through the use of FarmWorth.com. User is solely responsible for independently investigating and determining all information provided through FarmWorth.com prior to use and waives any and all claims against FarmWorth, LLC for any inaccuracies or inconsistencies in the information and/or data.

Code	Description	Acres	% of field	MN CPI	Drainage Class
414	Hamel loam, 0 to 2 percent slopes	27.27	24.88 %	94	Poorly drained
287	Minnetonka silty clay loam	17.47	15.94 %	77	Poorly drained
106C2	Lester loam, 6 to 10 percent slopes, moderately eroded	14.14	12.90 %	76	Well drained
238B	Kilkenny clay loam, 2 to 6 percent slopes	12.22	11.15 %	79	Moderately well drained
L113B	Reedslake-Le Sueur complex, 1 to 6 percent slopes	9.75	8.90 %	98	Moderately well drained
238C2	Kilkenny clay loam, 6 to 10 percent slopes, moderately eroded	9.15	8.35 %	74	Moderately well drained
L84A	Glencoe clay loam, 0 to 1 percent slopes	7.99	7.29 %	86	Very poorly drained
944B	Lester-Estherville complex, 2 to 6 percent slopes	5.15	4.70 %	77	Well drained
286B	Shorewood silty clay loam, 1 to 6 percent slopes	2.83	2.58 %	95	Moderately well drained
229	Waldorf silty clay loam, 0 to 2 percent slopes	2.37	2.16 %	85	Poorly drained
239	Le Sueur loam, 1 to 3 percent slopes	0.71	0.65 %	97	Somewhat poorly drained
L1207B	Le Sueur-Reedslake-Cordova complex, 0 to 5 percent slopes	0.56	0.51 %	95	Somewhat poorly drained
			Average:	84.5	

MN Productivity Index tables are obtained from the [NRCS Field Office Technical Guide](#)

Soils data provided by USDA and NRCS.